



Clean Heat

Rhode Island

Contractor Webinar

August 11, 2023



Clean Heat Rhode Island Team



**Danielle
Jameson**

Program
Administrator



**Christopher
Haringa**

Senior Program
Manager



Mike MacMillan

Incentive Processing
Manager



**Shannon
Bellamy**

Program Manager



**Justin
Bessette**

Heat Pump Specialist



Agenda

- Program launch and transition plans
- Program incentives & requirements
- Heat Pump Installer Network (HPIN) participation and enrollment
- Program resources
- Intro to the application portal and process for incentive applications



Program Launch -

August 2023

Clean Heat Rhode Island
officially launches
this month

SUN	MON	TUE	WED	THU	FRI	SAT
		1	2	3	4	5
6	7	8	9	10	11	12
13	14	15	16	17	18	19
20	21	22	23	24	25	26
27	28	29	30	31		

Transition Plans

- Enhanced Rebates → Clean Heat Rhode Island
 - All installations from program launch onward may be eligible for the new Clean Heat Rhode Island incentives
 - Rhode Island Energy standard per ton incentives will remain available and can be applied for separately
- Heat Pump Installer Network (HPIN)
 - To receive incentives, customers must work with a contractor on the Clean Heat Rhode Island HPIN
 - All enrolled Rhode Island Energy Participating Contractors will be temporarily enrolled into the Clean Heat Rhode Island Heat Pump Installer Network

No-Cost Heat Pump Consultation Service

Residential and Commercial customers can schedule a no-cost, virtual consultation with a Heat Pump Specialist where they can get assistance with:

- Understanding how heat pump systems work
- Available rebates and incentives
- Guidance on the best solution for their home or business
- Working with contractors
- Design review and quote comparison reports

Our Heat Pump Specialists are building science and heating/cooling experts. Our team can support customers with nearly any building type and at all stages of their project. Heat pump specialists are dedicated to providing impartial, objective advice.

Clean Heat Rhode Island Programs

Residential

Incentivizes:

- Air Source Heat Pumps
- Ground Source Heat Pumps
- Heat Pump Water Heaters
- Split-System HP Water Heaters
- Electrical Service Upgrades

Available to:

Single family or multifamily owners of individually metered & individually heated units.

Income Eligible

Incentivizes 100%:

- Air Source Heat Pumps
 - Heat Pump Water Heaters
- Including cost of electrical service upgrade up to \$3,000

Available to:

Recipients of SNAP, LIHEAP, or Rhode Island Energy Discount Rate

Commercial

Incentivizes:

- Air Source Heat Pumps
- VRF Heat Pumps
- Ground Source Heat Pumps
- Heat Pump Water Heaters
- Central Heat Pump Water Heaters

Available to:

Small to medium businesses with annual revenue of \$30 million or less and nonprofit organizations

Projects installed on or after **program launch** may be eligible for Clean Heat Rhode Island incentives.

Clean Heat Rhode Island

Incentives & Requirements

Program Requirements

- All equipment must be installed by a contractor participating in the Heat Pump Installer Network
- Installation & services performed must be in accordance with all codes, standards, regulations, and licensing requirements. This includes subcontractors.
- Incentives are available to all Rhode Island utility customers including Block Island Power Company, Pascoag Utility District, or Rhode Island Energy.
- Some projects will require additional quality assurance processing before incentives are processed.
- Must displace oil, propane, or natural gas heating. Partial fuel displacement is allowed, whole-building displacement is not required.

These incentives and requirements are subject to change at any time at the sole discretion of the Rhode Island Office of Energy Resources.

Program Requirements - Partial Displacement

- Must displace oil, propane, or natural gas heating. Partial fuel displacement is allowed, whole-building displacement is not required.
- **An attestation is required that the heat pump will be used for primary heating in the zone(s) it will heat and cool.**

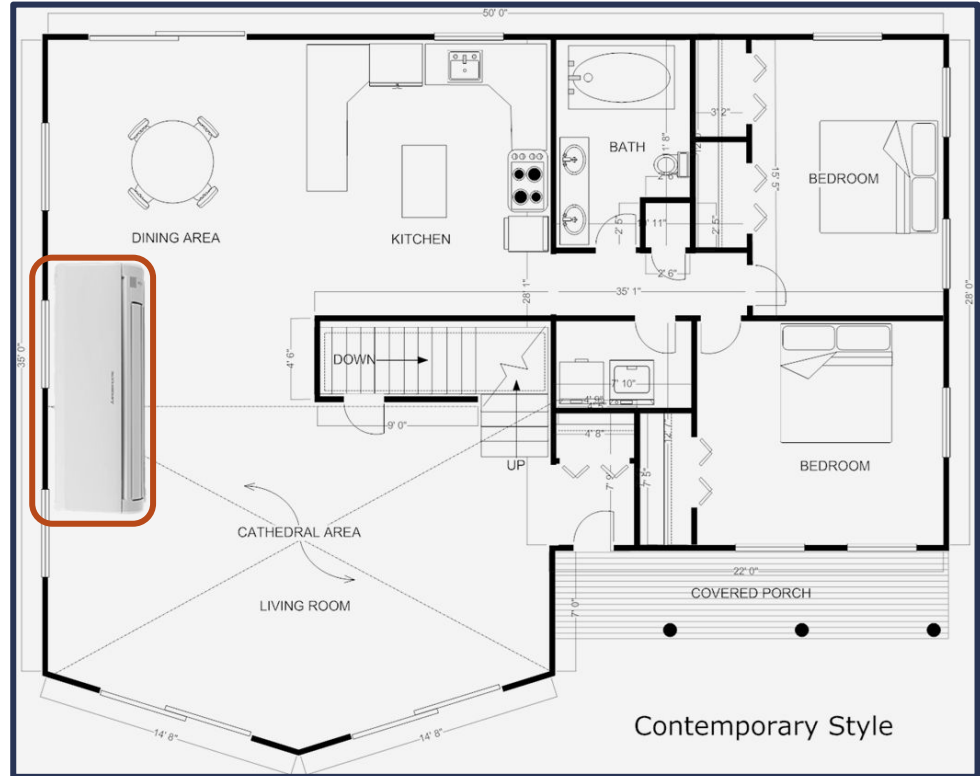

Residential Incentives & Requirements

Residential Incentive			
Equipment Type	Efficiency Requirement	Incentive Amount	
Air Source Heat Pump	Central Ducted	AHRI: SEER \geq 15, HSPF \geq 9; OR SEER2 \geq 14.3, HSPF2 \geq 7.7	\$1,000/ton
	Multizone Mix of Ducted and Non-Ducted	AHRI: SEER \geq 15, HSPF \geq 9; OR SEER2 \geq 14.3, HSPF2 \geq 7.7	
	Non-Ducted	NEEP's Cold Climate Heat Pump List	
Ground Source (Geothermal) Heat Pump	ENERGY STAR & AHRI Matched Equipment	\$1,250/ton	
Heat Pump Water Heater	ENERGY STAR certified UEF 3.30	\$750	
Heat Pump Water Heater (120volt/15amp circuit)	ENERGY STAR certified UEF 2.20	\$750	
Split-System Heat Pump Water Heater	ENERGY STAR certified UEF 2.20	\$1,500	
Electrical Service Upgrade	Installation of Air or Ground Source Heat Pump or Heat Pump Water Heater Required*	\$500	

Residential Incentives & Requirements

Residential Incentive Customer Eligibility

Equipment must be installed by a contractor listed on the Clean Heat Rhode Island Heat Pump Installer Network.

Single family or multifamily owners of an individually metered and individually heated unit may be eligible to receive this incentive.

Available to all Rhode Island utility customers including Block Island Power Company, Pascoag Utility District, or Rhode Island Energy.

Must displace oil, propane, or natural gas heating. Partial fuel displacement is allowed, whole-home displacement is not required.
- An attestation is required that the heat pump will be used for primary heating in the zone(s) it will heat and cool.

Must be on a residential electric utility rate. Exceptions may be made for residential farm buildings with commercial rate codes, or multi-use buildings with residential units on a case-by-case basis.

Residential incentives are capped at \$10,000 per household.

*Electrical service upgrade must coincide with the installation of a qualifying air or ground source heat pump or heat pump water heater

These incentives and requirements are subject to change at any time at the sole discretion of the Rhode Island Office of Energy Resources.

Residential New Construction & Renovations Incentives & Requirements

Residential New Construction Incentive

Equipment Type		Efficiency Requirement	Incentive Amount
Air Source Heat Pump	Central Ducted	AHRI: SEER \geq 15, HSPF \geq 9; OR SEER2 \geq 14.3, HSPF2 \geq 7.7	\$750/ton
	Multizone Mix of Ducted and Non-Ducted	AHRI: SEER \geq 15, HSPF \geq 9; OR SEER2 \geq 14.3, HSPF2 \geq 7.7	
	Non-Ducted	NEEP's Cold Climate Heat Pump List	
Ground Source (Geothermal) Heat Pump		ENERGY STAR & AHRI Matched Equipment	\$750/ton

Residential New Construction Customer Eligibility

Available to all Rhode Island utility customers including Block Island Power Company, Pascoag Utility District, and Rhode Island Energy.

Must be a new construction home or renovation/addition totaling \geq 400 new sq. ft. of conditioned space.

- An attestation is required to confirm renovation/addition size.

- An attestation is required that the heat pump will be used for primary heating in the zone(s) it will heat and cool.

These incentives and requirements are subject to change at any time at the sole discretion of the Rhode Island Office of Energy Resources.

Income-Eligible Incentives & Requirements

Residential Income-Eligible Incentive		
Equipment Type	Efficiency Requirement	Incentive Amount
Air Source Heat Pump	NEEP's Cold Climate Heat Pump List & Weatherization	100% of cost including electrical service upgrade
Heat Pump Water Heater	ENERGY STAR certified UEF 3.30	100% of cost including electrical service upgrade
Heat Pump Water Heater (120volt/15amp circuit)	ENERGY STAR certified UEF 2.20	100% of cost including electrical service upgrade

Income-Eligible Incentives & Requirements

Pre-approval for income-eligible incentives is required prior to installation.

Residential Income-Eligible Customer Eligibility

Single family or multifamily owners of an individually metered and individually heated unit may be eligible to receive this incentive.

Available to All Rhode Island utility customers including Block Island Power Company, Pascoag Utility District, and Rhode Island Energy

Any of the following programs will qualify a customer for the income-eligible program: SNAP, LIHEAP, or Rhode Island Energy Discount Rate.

- Alternatively, customers can be income-qualified through the application process. More information is available on program website.

Must displace oil or propane heating. **Natural gas is not eligible.** Partial fuel displacement is allowed; whole-home displacement is not required.

- An attestation is required that the heat pump will be used for primary heating in the zone(s) it will heat and cool.

Electrical Service upgrade incentive not to exceed \$3,000.

All projects are subject to a quality assurance process by the Clean Heat Rhode Island program administrators.

These incentives and requirements are subject to change at any time at the sole discretion of the Rhode Island Office of Energy Resources.

Commercial Incentives

Commercial Heat Pump Incentives

Equipment Type	Equipment Capacity	EER	IEER	COP	Incentive	16 Tons Max Amount	
Air Source Heat Pumps	<5.4 tons	See Residential Requirements			\$2,500/ton	\$40,000	
	≥ 5.4 Tons and < 11.3 Tons	11.8	15.4	3.5			
	≥ 11.3 Tons and < 16 Tons	10.9	14.6	3.4			
Variable Refrigerant Flow (VRF) Heat Pumps	≥ 5.4 Tons and < 11.3 Tons	11.3	18.9	3.4 @ 47F	\$3,500/ton	\$56,000	
	≥ 11.3 Tons and < 16 Tons	10.9	18	3.3 @ 47F			
Ground Source Heat Pumps (Closed Loop)	Brine to Air	< 11.3 Tons	17.1	-	3.6	\$4,500/ton	\$72,000
	Brine to Water	< 5.4 Tons	16.1	-	3.1		
		≥ 5.4 Tons and < 11.3 Tons	16.1	-	3		
Heat Pump Water Heater	≤ 80 Gallon	UEF ≥ 3.2			\$1,000	N/A	
	81-120 Gallon	COP ≥ 3.6			\$2,200		
Central Heat Pump Water Heater	≥120 Gallon	COP ≥ 3.5			\$2,500/ton	\$40,000	

Commercial Incentive Requirements

Pre-approval for commercial incentives is required prior to installation.

Commercial Incentive Customer Eligibility

Must be small to medium-sized business with annual gross revenue in the prior year of less than \$30 million or a nonprofit organization.

Available to all Rhode Island utility commercial customers including Block Island Power Company, Pascoag Utility District, and Rhode Island Energy.

Must displace oil, propane, or natural gas heating. Partial fuel displacement is allowed, whole-building displacement is not required.
- An attestation is required that the heat pump will be used for primary heating in the zone(s) it will heat and cool.

Incentive amounts will be capped at 16 tons although installed equipment may be larger than 16 tons.

These incentives and requirements are subject to change at any time at the sole discretion of the Rhode Island Office of Energy Resources.

Clean Heat Rhode Island
Heat Pump Installer Network
(HPIN)

Heat Pump Installer Network - Benefits

Clean Heat Rhode Island offers the following benefits to contractors:

- Access to Clean Heat Rhode Island incentives for customers
- Listing on the program website & leads through the contractor locator tool
- Marketing materials and sales tools including customer brochures and flyers
- Regular e-newsletters, including program updates, upcoming industry trainings, and installation best practices.



Heat Pump Installer Network - Requirements

- All enrolled Rhode Island Energy Participating Contractors will be temporarily enrolled into the Clean Heat Rhode Island Heat Pump Installer Network
- This grace period lasts **3 months**
- Contractors must enroll & provide the following information to stay on the list:
 - Appropriate licenses
 - W-9
 - Certificate of insurance
 - EPA 608
- Required within the 1st year of participation:
 - Manufacturer install training (Air and ground source heat pump contractors)
 - Manufacturer cold climate training (Air source only)

Heat Pump Installer Network - How to Enroll

- Visit CleanHeatRI.com/enroll after program launch
 - Sign the Participating Installer Agreement
 - Provide required documentation

Grace Period for those on Rhode Island Energy's Participating Contractor List lasts for **3 months**

Application Portal

Contractor/Applicant Log-In Process

Contractor Portal Enrollment - Create an Account

User Registration

Your Login

Email REQUIRED

Password REQUIRED

Confirm Password REQUIRED

Password must be at least 8 characters long and contain a mix of upper case letters, lower case letters, numbers and special characters.

Your Information

First Name REQUIRED

Last Name REQUIRED

Your Address

Company Name

Provide your company name if you are an installer

Street REQUIRED

Apartment or Suite

City REQUIRED

State REQUIRED

-- Select One --

Zip Code REQUIRED

Phone REQUIRED

Enter 123-123-1234 with no extensions allowed

Create account!

Create Account

Cancel

Create an account on the Clean Heat Rhode Island application portal.

Activate your account by clicking the link in the email you receive.

Once your account is activated, log in to the application portal.

Contractor Portal Enrollment - Applicant Info

Welcome to Clean Heat Rhode Island

Applicant Information

Are you an installer or the homeowner? **REQUIRED**

-- Specify One --



Submit

Select your role as either an installer or homeowner.

Installers should select their company name from the dropdown menu.

If you do not see your company name on the dropdown menu you will need to complete the installer registration form to be added to the Heat Pump Installer Network. Instructions on doing so will be emailed to you.

Pre-Approval: Project Dashboard

INFORMATION APPLICATION REVIEW ABODE OER ADMIN SYSTEMWelcome Micha

Your Application Dashboard

[Begin New Application](#)  Begin a new application.

Show

App ID	Project Name	Application Status	Information Needed
59	Mike Test August 4th	<div data-bbox="778 598 1145 616" style="width: 50%;"><div data-bbox="933 601 991 616">50%</div></div> Step 3 of 4 Continue »	
56	Mike Test Aug 1	<div data-bbox="778 663 1145 682" style="width: 75%;"><div data-bbox="1029 667 1068 682">75%</div></div> Step 4 of 4 Continue »	
16	Mike Test 2	<div data-bbox="778 729 1145 748" style="width: 75%;"><div data-bbox="1029 732 1068 748">75%</div></div> Step 4 of 4 Continue »	
4	Mike Test 1	Submitted	

Search App: Search Status: Search Information Needed:

Showing 1 to 4 of 4 entries Previous 1 Next

© InClimate, Inc. 2023. All Rights Reserved. View our Privacy Policy

Application

Part 1: Pre-Approval

Pre-Approval: Step 3 - Begin New Application

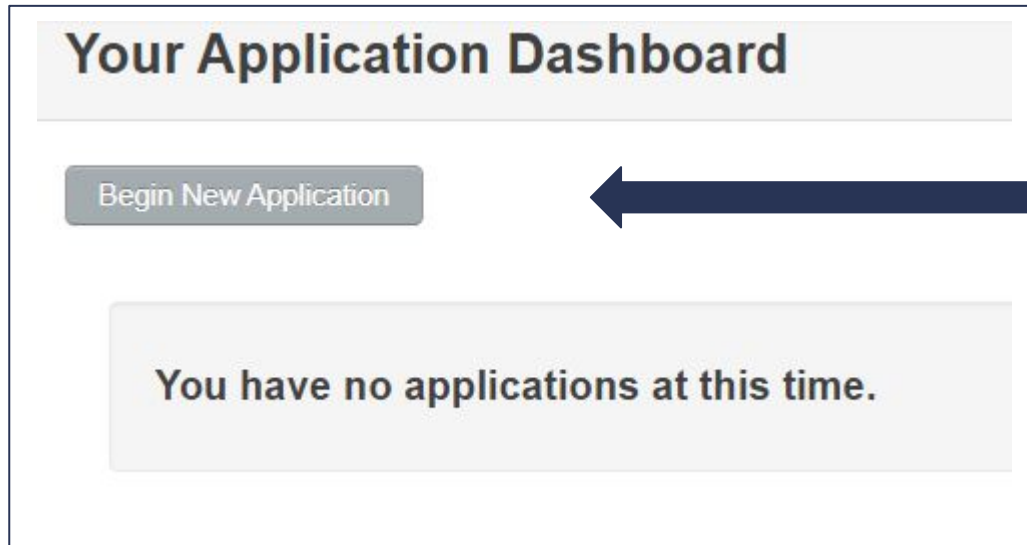

Begin a new application.

Pre-Approval: Step 1 - Project Information

Project Name REQUIRED

A personalized name for your project

Installer Information

Select your installer REQUIRED

If your installer is not on this list, see [Information for Homeowners](#) on the right side of this page

Installation Location

[Use my contact information »](#)

Street

Apartment or Suite

City REQUIRED

State REQUIRED

Zip Code REQUIRED

Enter your project name, installer name, and the address of the installation.

Pre-Approval: Step 2 - Residence information

Electric Utility

Electric Utility REQUIRED

Rhode Island Energy

Electric Utility Account Number REQUIRED

789456

Building Information

Building Type: Residential

Residence Type REQUIRED

Single Family Detached Ho

Is the residence located in a mixed-use building? REQUIRED

No

A mixed-use building includes both residential and commercial units

Is the residence located on a farm? REQUIRED

No

Construction Information

Construction Type REQUIRED

Existing Construction (Repl

[Save and Continue](#) [Exit](#)

Complete Step 2 of the application by providing information about your utility account and your residence.

Construction Information

Construction Type REQUIRED

Addition to Existing Constru

Addition to Existing Construction area size in square feet REQUIRED

0

Must be at least 400 new square feet of conditioned space

Pre-Approval: Step 3 - Equipment

Equipment to be Installed

Are you installing a Heat Pump for space heating and cooling? **REQUIRED**

Yes

Heating fuel type being replaced **REQUIRED**

-- Specify One --

Equipment being replaced **REQUIRED**

-- Specify One --

Will new equipment completely replace the existing equipment? **REQUIRED**

-- Specify One --

Are you installing a Heat Pump Water Heater? **REQUIRED**

-- Specify One --

Enter information about the heat pump or heat pump water heater being installed.

Heat Pump Details

Heat Pump Type **REQUIRED**

-- Specify One --

Heat Pump AHRI Reference Number **REQUIRED**

Enter a second heat pump

Enter a third heat pump

Total Heat Pump System Cooling Capacity (tons) **REQUIRED**

Expected Installation Date **REQUIRED**

Please Enter in YYYY-MM-DD format

Total Estimated Heat Pump System Cost **REQUIRED**

Do not include \$ or commas

Pre-Approval: Step 4 - Documents

Review your incentive amount and upload the required documents:

- Utility bill
- Heat pump proposal

Additionally, read and sign the primary heat attestation.

Required Documents

Utility Bill REQUIRED

No file chosen

Heat Pump Proposal REQUIRED

No file chosen

Optional Uploads

Optional Document

No file chosen

Pre-Approval: Step 4 - Attestations

Read and sign the primary heat attestation and acceptance of terms.

Certification and Signature REQUIRED

Primary Heat Source:

Heat pump systems should be designed to ensure customers are utilizing the heat pumps as their primary heat source whether partially or fully displacing the pre-existing fossil fuel system. The homeowner or tenant attests that **the installed heat pump will be used as the primary heat source** throughout the heating season in the areas where it heats and cools. If the heat pump is only designed to partially displace the heating load, the homeowner or tenant will only use backup heat as necessary.

Customer Acceptance of Terms:

I certify that all statements and information, including any attachments, made in this verification form are correct, complete, true, and accurate to the best of my knowledge, and that I have read and agree to the [Clean Heat Rhode Island Terms and Conditions](#). I understand that any false, fraudulent or incorrect information in this form or any of the attachments is grounds for nonpayment or return of any rebates, suspension or termination from future Clean Heat Rhode Island programs and may be subject to referral to applicable government agencies for further appropriate action.

Full Name of Signatory REQUIRED

August 2, 2023, 12:08 PM

Pre-Approval: Step 4 - Attestations

Congratulations!

You have successfully submitted your Clean Heat Rhode Island Rebate Application.

We will review your application and contact you if we need additional information. Upon approval, we will notify you to request post-installation information.

Please note:

- You may be required to provide quality assurance documentation in order to receive your rebate.
- Equipment must be installed no more than 90 days from today.

[Go to my Application Dashboard](#)

Application

Part 2: Final Approval

Final Approval (Part 2): Step 5 - Install Date & Payment

Application Summary

Heat Pump for Space Heating and Cooling

Type: Air Source Heat Pump

AHRI Reference Number(s): 206223052

Total Heat Pump System Cooling Capacity (tons): 4.0

Pending Total Rebate: \$4,000.00

Note: Rebates are subject to final application approval.

Installation Information

Heat Pump Installation Date REQUIRED

2023-08-07

Please Enter in YYYY-MM-DD format

Total Heat Pump Cost REQUIRED

18000

Do not include \$ or commas

Payment Information

Rebate Payment Recipient REQUIRED

Property Owner

Bank Account Type REQUIRED

-- Specify One --

Name of Bank REQUIRED

Name of Account Holder REQUIRED

Bank Routing Number REQUIRED

Bank Account Number REQUIRED

Final Approval (Part 2) : Step 6 - Document Uploads

Application Summary

Heat Pump for Space Heating and Cooling

Type: Air Source Heat Pump

AHRI Reference Number(s): 206223052

Total Heat Pump System Cooling Capacity (tons): 4.0

Pending Total Rebate: \$4,000.00

Note: Rebates are subject to final application approval.

Required Documents

Heat Pump Invoice **REQUIRED**

No file chosen

Optional Uploads

Optional Document

No file chosen

Allowed File Types for Uploads:

pdf, jpeg, jpg, png, gif, docx, doc

Final Invoice Requirements

- Invoices must show brand names and model numbers for all installed heat pumps.
- If the rebate recipient is the installer, the invoice must show the rebate amount deducted from the total cost.

Final Approval:

Congratulations!

You have successfully submitted your Clean Heat Rhode Island Rebate Application.

We will review your application and contact you if we need additional information.

Thank you for participating in the Clean Heat Rhode Island program.

[Go to my Application Dashboard](#)

Your Dashboard



Clean Heat
Rhode Island

INFORMATION

APPLICATION

Welcome Shannon

Your Application Dashboard

Begin New Application

Show 10 ▾

App ID ▾	Project Name ▾	Application Status ▾	Information Needed ▾
58	Test 3	<div style="background-color: #ccc; width: 75%; text-align: right;">75%</div> Step 4 of 4 Continue »	
54	Test 2	Submitted	
46	Test 1	<div style="background-color: #ccc; width: 75%; text-align: right;">75%</div> Step 4 of 4 Continue »	
Search App	<input type="text" value="Search Project"/>	<input type="text" value="Search Status"/>	<input type="text" value="Search Information Needed"/>

Showing 1 to 3 of 3 entries

Previous 1 Next

Clean Heat Rhode Island
Program Resources

AIR SOURCE HEAT PUMP QUALITY INSTALLATION CHECKLIST

Clean Heat Rhode Island offers incentives to assist homeowners and small-to-mid-size business owners with the purchase and installation of high-efficiency electric heat pumps.

Air source heat pump installations receiving residential or commercial rebates should be completed in accordance with the quality installation check list below:

Outdoor Unit	<input type="checkbox"/> Level side-to-side and front-to-back, and on proper base, secure
	<input type="checkbox"/> Greater than or equal to 12" above ground
	<input type="checkbox"/> Clearance from obstructions including walls, overhangs, protrusions, etc. (minimum 4" to rear)
	<input type="checkbox"/> Protected from roof runoff by gutter, rain cap, gable end, or overhang
Indoor Unit	<input type="checkbox"/> Ductless units installed so that the air discharge is no higher than 8' from the floor
	<input type="checkbox"/> Thermostats installed on interior walls, away from direct sunlight, appliances, and drafts
	<input type="checkbox"/> All ductwork insulated to R8 and sealed, if applicable
Line Set	<input type="checkbox"/> Floor, wall, and ceiling penetrations properly sealed
	<input type="checkbox"/> Visible line sets run through line set covers with transition and termination fittings
	<input type="checkbox"/> Insulation must cover entire line set length and UV-resistant tape or other protection shall be installed as needed to protect exposed insulation
	<input type="checkbox"/> Condensate line installed without dips or traps, away from crawl spaces, walkways, and other outdoor equipment
	<input type="checkbox"/> Line sets pressure tested using dry nitrogen and evacuated with a vacuum pump per the manufacturer's instructions
Integrated Control (if applicable)	<input type="checkbox"/> If utilizing a droop setting or automatic changeover from heat pump to backup heating system, configured to prioritize the heat pump over the backup heating system

For more information, visit CleanHeatRI.com



CLEAN HEAT RHODE ISLAND PROGRAM OVERVIEW



Customer Assistance

Learn more, ask questions & receive guidance



Participating Installers

Work with an installer in our network



Review Quotes

Compare up to three quotes



Financial Incentives

Reduce installation costs

GET STARTED TODAY!

- 1 Schedule a consultation with our Heat Pump Specialist.
- 2 Work with a participating installer to determine if a heat pump is right for you.
- 3 You may submit your quotes through our portal and receive a comparison report.
- 4 You or your installer reserves a rebate with a project pre-approval. Once approved, your new heating and cooling system is installed.
- 5 You or your installer completes the rebate application; some projects may require inspection before rebates are processed.
- 6 The rebate is processed. Enjoy your new efficient heating and cooling system!

Learn more at
CleanHeatRI.com

Air Source Heat Pumps

How They Work

The graphic below represents an ASHP process in heating mode. The process is simply reversed when in cooling mode. This process uses a refrigerant, which is a type of liquid that absorbs and releases heat quickly, similar to refrigerants that you add to your car's AC system or the coil behind your refrigerator.

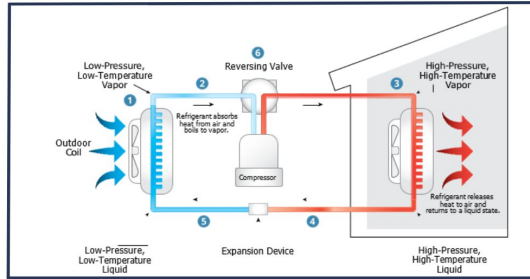

- 1 A fan blows air over a system of coils with very cold, low pressure refrigerant which absorbs heat from the outside air. Heat can be drawn from the air even when it's very cold out.
- 2 The refrigerant flows to the compressor which mechanically increases the pressure of the refrigerant, causing the captured heat to warm up even more.
- 3 The refrigerant moves to the indoor unit and releases heat.
- 4 The refrigerant then moves to the expansion device, lowering the pressure of the refrigerant, which makes it very cold again.
- 5 The refrigerant returns to the outdoor unit to begin the cycle again.
- 6 The reversing valve is responsible for directing the flow of the refrigerant when switching between heating and cooling mode.

When shopping around for a heat pump, look for a system with a high heating seasonal performance factor (HSPF2) greater than 7.7 and a Seasonal Energy Efficiency Rating (SEER2) greater than 14.3. These indicate that the system works efficiently in our climate.



Contact Us



401-341-6183



CleanHeatRI@AbodeEM.com



Questions



Clean Heat

Rhode Island

